



Onondaga County Legislature

DEBRA J. CODY

County Legislator – 5th District
107 Circle Road, N. Syracuse, New York 13212
Leg (315) 435-2070 • Cell (518) 421-0022
debjcody@gmail.com

COUNTY FACILITIES COMMITTEE AGENDA

Livestream Available: <https://www.facebook.com/OnondagaCountyLegislature>

11:30 a.m.
February 20, 2024

401 Montgomery St., Room 407 Court House
Syracuse, New York 13202

- A. Approval of the minutes of the previous meeting.
- B. Presentation of Resolutions and Local Laws:

1. ONONDAGA COMMUNITY COLLEGE:

- a. Confirming Appointments to the Onondaga Community College Board of Trustees
(William Gilberti, Jaime Alicea)

2. TRANSPORTATION:

- a. Authorizing the Acquisition of Real Property in the Town of Clay for Highway Purposes (\$400)

3. FACILITIES MANAGEMENT:

- a. 2023 Transfer Resolution (\$210,000)
- b. 2023 Transfer Resolution (\$1,000,000)

4. PARKS & RECREATION:

- a. 2023 Transfer Resolution (\$125,000)

5. ONONDAGA COUNTY PUBLIC LIBRARY (OCPL):

- a. 2023 Transfer Resolution (\$115,500)

6. ONONDAGA HISTORICAL ASSOCIATION:

- a. INFORMATIONAL: Update from Lisa Romano Moore, Executive Director

- C. Adjournment

March 5, 2024

Motion Made By Ms. Cody

RESOLUTION NO. _____

CONFIRMING APPOINTMENTS TO THE ONONDAGA COMMUNITY COLLEGE BOARD OF TRUSTEES

WHEREAS, J. Ryan McMahon, II, Onondaga County Executive, has duly appointed/reappointed and designated pursuant to Section 6306 of the New York State Education Law, Section 1903 of the Onondaga County Charter and Section 24.01 of the Onondaga County Administrative Code, subject to confirmation by the Onondaga County Legislature, the following individuals as members of the Onondaga Community College Board of Trustees:

APPOINTMENT:

William Gilberti
3235 Lanning Road
Skaneateles, New York 13152

TERM EXPIRES:

November 1, 2030

REAPPOINTMENT:

Jaime Alicea
103 Phillips Road
Syracuse, New York 13214

TERM EXPIRES:

October 4, 2030

WHEREAS, it is the desire of this Legislature to confirm said appointments; now, therefore be it

RESOLVED, that the Onondaga County Legislature does hereby confirm the appointment/reappointment of the above individuals as members of the Onondaga Community College Board of Trustees for the term specified above or until subsequent action by the County Executive.



1a

County of Onondaga
Office of the County Executive

John H. Mulroy Civic Center, 14th Floor
421 Montgomery Street, Syracuse, New York 13202

Phone: 315.435.3516 Fax: 315.435.8582

www.ongov.net

J. Ryan McMahon, II
County Executive

Ann Rooney
Deputy County Executive, Human Services

Brian J. Donnelly
Deputy County Executive

Mary Beth Primo
Deputy County Executive, Physical Services

January 23, 2024

TO THE HONORABLE MEMBERS OF THE ONONDAGA COUNTY LEGISLATURE:

Pursuant to Article XXIV, Section 24.01, of the Onondaga County Administrative Code, and Article XIX, Section 1903, of the Onondaga County Charter, I have reappointed /appointed, subject to confirmation of the County Legislature, the following individuals to serve as members of the OCC Board of Trustees:

REAPPOINTMENT:

Jaime Alicea
103 Phillips Road
Syracuse, NY 13214

TERM EXPIRES:

October 4, 2030

APPOINTMENT:

William Gilberti
3235 Lanning Road
Skaneateles, NY 13152

TERM EXPIRES:

November 1, 2030

Mr. Gilberti will be replacing Ms. Tara Owens

Your confirmation of these appointments would be greatly appreciated.

Sincerely,

J. Ryan McMahon, II
County Executive

cc: Deb Cody, Chair, County Facilities Committee
Ben Yaus., Law Department
Jamie McNamara, County Legislature
Dr. Warren Hilton, President, OCC
Sue Tormey, OCC

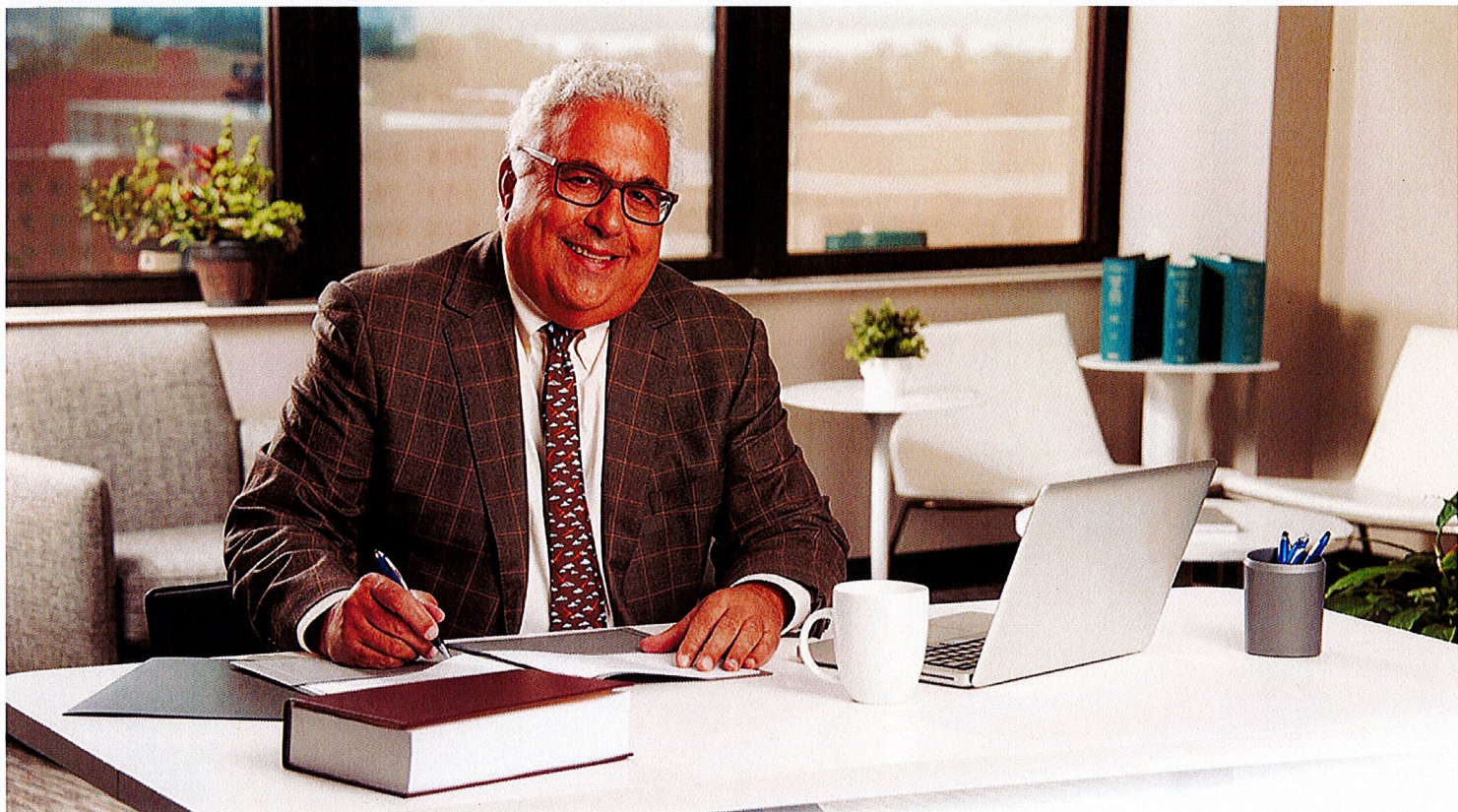

Bill Gilberti

Partner

"I've dedicated myself to getting the best results for every client. In that endeavor, I'm willing push legal boundaries and create new law."

Syracuse

P: 315.413.7272

M: 315.427.3386

wgilberti@barclaydamon.com

Overview

Biography

The former managing partner and CEO of Gilberti Stinziano Heintz & Smith, PC, Bill is a seasoned litigator who represents clients before federal and state courts and state administrative agencies, including the NYS Department of Environmental Conservation (NYSDEC), the Adirondack Park Agency, and the Public Service Commission (PSC). He regularly advocates on behalf of his clients to defend or challenge compliance with state and federal environmental laws and regulatory regimes, including solid-waste disposal, water quality, and the Navigation Law as well as local land-use determinations.

Bill additionally provides strategic legal counsel to public- and private-sector clients on large-scale project development, including the build-out of a statewide wireless communications network , a proposal to construct the world's longest underground direct-current electric-transmission line, brownfield site development, and the construction of the region's largest tourism destination facility.

Under Bill's leadership at Gilberti, the firm's environmental group cultivated one of the state's largest mining and related transportation industry practices, representing many of the key players in the state's

construction aggregates industry. He was also the principal architect of legal arguments that helped define key principles of environmental law under both the State Environmental Quality Review Act (SEQRA) and the Mined Land Reclamation Law (MLRL).

Bar Associations

- Federal Bar Council
- National Italian American Bar Association
- New York State Bar Association
- Onondaga County Bar Association

Selected Memberships & Affiliations

- Associated General Contractors
- New York Construction Materials Association
- National Association of State Land Reclamationists
- NYS Association of Solid Waste Management

Experience

Representative Experience

- Served as lead counsel to one of the largest developers in the Northeast in the development of the region's largest tourism destination facility on a brownfield site, including advising on project structure and incentives, SEQRA compliance, and eminent domain. Successfully served as litigation counsel in numerous related actions concerning condemnation, lender obligations, brownfields, and project development.
- Spearheaded the legal team representing the State of New York in the development and deployment of the Statewide Wireless Network, a coordinated mobile network of over 1,200 interconnected receiving and transmitting antenna sites for emergency communication services to public safety and service agencies.
- Served as lead counsel to a developer in a PSC Article VII proceeding on a proposed HVDC underground transmission line involving 260 miles of underground cable, underground to aboveground transition facilities, converters, and substations.
- Headed the legal team providing environmental, permitting, and transaction legal services for a large mixed-use commercial, residential, and retail project totaling over 200,000 square feet in an archaeologically sensitive area of downtown Albany, New York.
- Directed a litigation effort that successfully challenged the NYSDEC's proposed regulations requiring diesel-engine retrofits to reduce air pollution, resulting in a decision, affirmed on appeal, that the agency had exceeded its authority by imposing the retrofit requirements on a larger class of vehicles than the legislature had intended.
- Represented the nation's largest underground salt mine in proceedings before the NYSDEC to obtain authority under the MLRL to add 5,056 permitted acres of underground reserves, bringing the total permitting acreage to over 13,000 acres.
- Directed the legal effort of a team representing a NYS medical-marijuana client in successfully registering as a registered organization under the Compassionate Care Act. The women-owned business was one of five successful registrants out of 43 applicants.
- Acted as co-counsel in action brought on behalf of multiple clients challenging the authority of the NYS Workers' Compensation Board to assess former members of defaulted group self-insured trusts for past trust liabilities. The litigation resulted in a favorable settlement to the client group.

Prior Experience

- Gilberti Stinziano Heintz & Smith, P.C., Managing Partner and Chief Executive Officer

Selected Honors

- *The Best Lawyers in America*®: Environmental Law, 2022–2024
- Martindale-Hubbell AV Preeminent Peer Review–Rated for Very High to Preeminent Ethical Standards and Legal Ability, 2022
- Selected to *Super Lawyers* Upstate New York: 2009–2010

Knowledge

Education

- Syracuse University College of Law, JD, *Magna Cum Laude*
- University of Miami, BA

Practices & Industries

- Regulatory
- Project Development
- Environmental
- Energy
- Land Use & Zoning

Admitted to Practice

- New York
- Pennsylvania

Court Admissions

- US Court of Appeals for the Second Circuit
- US District Court for the Northern District of New York
- US District Court for the Western District of New York

March 5, 2024

Motion Made By Ms. Cody

RESOLUTION NO. _____

AUTHORIZING THE ACQUISITION OF REAL PROPERTY IN THE TOWN OF CLAY FOR
HIGHWAY PURPOSES

WHEREAS, this Onondaga County Legislature has reviewed the real property rights necessary for highway improvements to Oak Orchard Road, C.R. 187, at its intersection with Youngs Creek; and

WHEREAS, an appraisal has been obtained from a certified appraiser, as required by the Eminent Domain Procedure Law, and the value thereof is designated by the map number at the amount specified as follows:

<u>NAME:</u>	<u>TAX MAP NO.:</u>	<u>MAP:</u>	<u>TYPE:</u>	<u>SIZE:</u>	<u>AMOUNT:</u>
Christopher Sappe	043.-01-45.0	1	Fee	0.05A±	\$400.00

and

WHEREAS, the above amount is considered fair and reasonable for the property rights to be acquired; now, therefore be it

RESOLVED, that the proposed action is an Unlisted action for the purposes of the New York State Environmental Quality Review Act (SEQRA); and, be it further

RESOLVED, that the Short Environmental Assessment Form (SEAF) for this project has been completed and reviewed and is on file with the Clerk of the Legislature; and, be it further

RESOLVED, that this Legislature hereby finds and declares a negative declaration under SEQRA, having determined that such action will not have a significant adverse effect on the environment; and, be it further

RESOLVED, that the Department of Transportation be and is hereby authorized to acquire necessary real property rights on the above-referenced parcel for an amount not to exceed \$400.00 for lawful county purposes; and, be it further

RESOLVED, that the County Comptroller be, and hereby is, directed to draw a check payable to the current owner of the parcel acquired in payment thereof, said check to be delivered to the County Attorney who shall obtain proper conveyance and approve title before delivery of said check, and that said sum be, and hereby is made a charge upon the proper fund or funds; and, be it further

RESOLVED, that if the offer is not accepted by the property owner, that the County Attorney, on behalf of the County of Onondaga be, and hereby is, authorized and directed to commence condemnation proceedings to acquire the property pursuant to the statutes in such cases made and provided, and the cost of said property be charged against the proper fund or funds; and, be it further

RESOLVED, that the County Executive, or his designee, is authorized to take such actions to comply with the requirements of SEQRA, including without limitation, the execution of documents and the filing, distribution and publication of the SEAF and Negative Declaration, and any other actions to implement the intent of this resolution.

Short Environmental Assessment Form

Part 1 - Project Information

Instructions for Completing

Part 1 – Project Information. The applicant or project sponsor is responsible for the completion of Part 1. Responses become part of the application for approval or funding, are subject to public review, and may be subject to further verification. Complete Part 1 based on information currently available. If additional research or investigation would be needed to fully respond to any item, please answer as thoroughly as possible based on current information.

Complete all items in Part 1. You may also provide any additional information which you believe will be needed by or useful to the lead agency; attach additional pages as necessary to supplement any item.

Part 1 – Project and Sponsor Information				
Name of Action or Project:				
Project Location (describe, and attach a location map):				
Brief Description of Proposed Action:				
Name of Applicant or Sponsor:			Telephone:	
			E-Mail:	
Address:				
City/PO:			State:	Zip Code:
1. Does the proposed action only involve the legislative adoption of a plan, local law, ordinance, administrative rule, or regulation?			NO	YES
If Yes, attach a narrative description of the intent of the proposed action and the environmental resources that may be affected in the municipality and proceed to Part 2. If no, continue to question 2.			<input type="checkbox"/>	<input type="checkbox"/>
2. Does the proposed action require a permit, approval or funding from any other government Agency?			NO	YES
If Yes, list agency(s) name and permit or approval:			<input type="checkbox"/>	<input type="checkbox"/>
3. a. Total acreage of the site of the proposed action? _____ acres b. Total acreage to be physically disturbed? _____ acres c. Total acreage (project site and any contiguous properties) owned _____ acres or controlled by the applicant or project sponsor?				
4. Check all land uses that occur on, are adjoining or near the proposed action: 5. Urban Rural (non-agriculture) Industrial Commercial Residential (suburban) <input type="checkbox"/> Forest Agriculture Aquatic Other(Specify): <input type="checkbox"/> Parkland				

5. Is the proposed action,	NO	YES	N/A
a. A permitted use under the zoning regulations?	<input type="checkbox"/>	<input type="checkbox"/>	<input type="checkbox"/>
b. Consistent with the adopted comprehensive plan?	<input type="checkbox"/>	<input type="checkbox"/>	<input type="checkbox"/>
6. Is the proposed action consistent with the predominant character of the existing built or natural landscape?	NO	YES	
	<input type="checkbox"/>	<input type="checkbox"/>	
7. Is the site of the proposed action located in, or does it adjoin, a state listed Critical Environmental Area?	NO	YES	
If Yes, identify: _____	<input type="checkbox"/>	<input type="checkbox"/>	
8. a. Will the proposed action result in a substantial increase in traffic above present levels?	NO	YES	
	<input type="checkbox"/>	<input type="checkbox"/>	
b. Are public transportation services available at or near the site of the proposed action?	<input type="checkbox"/>	<input type="checkbox"/>	
c. Are any pedestrian accommodations or bicycle routes available on or near the site of the proposed action?	<input type="checkbox"/>	<input type="checkbox"/>	
9. Does the proposed action meet or exceed the state energy code requirements?	NO	YES	
If the proposed action will exceed requirements, describe design features and technologies: _____ _____	<input type="checkbox"/>	<input type="checkbox"/>	
10. Will the proposed action connect to an existing public/private water supply?	NO	YES	
If No, describe method for providing potable water: _____ _____	<input type="checkbox"/>	<input type="checkbox"/>	
11. Will the proposed action connect to existing wastewater utilities?	NO	YES	
If No, describe method for providing wastewater treatment: _____ _____	<input type="checkbox"/>	<input type="checkbox"/>	
12. a. Does the project site contain, or is it substantially contiguous to, a building, archaeological site, or district which is listed on the National or State Register of Historic Places, or that has been determined by the Commissioner of the NYS Office of Parks, Recreation and Historic Preservation to be eligible for listing on the State Register of Historic Places?	NO	YES	
	<input type="checkbox"/>	<input type="checkbox"/>	
b. Is the project site, or any portion of it, located in or adjacent to an area designated as sensitive for archaeological sites on the NY State Historic Preservation Office (SHPO) archaeological site inventory?	<input type="checkbox"/>	<input type="checkbox"/>	
13. a. Does any portion of the site of the proposed action, or lands adjoining the proposed action, contain wetlands or other waterbodies regulated by a federal, state or local agency?	NO	YES	
	<input type="checkbox"/>	<input type="checkbox"/>	
b. Would the proposed action physically alter, or encroach into, any existing wetland or waterbody?	<input type="checkbox"/>	<input type="checkbox"/>	
If Yes, identify the wetland or waterbody and extent of alterations in square feet or acres: _____ _____ _____			

14. Identify the typical habitat types that occur on, or are likely to be found on the project site. Check all that apply: <input checked="" type="checkbox"/> Shoreline <input type="checkbox"/> Forest <input checked="" type="checkbox"/> Agricultural/grasslands <input type="checkbox"/> Early mid-successional <input type="checkbox"/> Wetland <input type="checkbox"/> Urban <input type="checkbox"/> Suburban		
15. Does the site of the proposed action contain any species of animal, or associated habitats, listed by the State or Federal government as threatened or endangered? Bald Eagle, Indiana Bat	NO	YES
	<input type="checkbox"/>	<input checked="" type="checkbox"/>
16. Is the project site located in the 100-year flood plan?	NO	YES
	<input checked="" type="checkbox"/>	<input type="checkbox"/>
17. Will the proposed action create storm water discharge, either from point or non-point sources? If Yes,	NO	YES
	<input checked="" type="checkbox"/>	<input type="checkbox"/>
a. Will storm water discharges flow to adjacent properties?	<input type="checkbox"/>	<input type="checkbox"/>
b. Will storm water discharges be directed to established conveyance systems (runoff and storm drains)? If Yes, briefly describe:	<input type="checkbox"/>	<input type="checkbox"/>

18. Does the proposed action include construction or other activities that would result in the impoundment of water or other liquids (e.g., retention pond, waste lagoon, dam)? If Yes, explain the purpose and size of the impoundment:	NO	YES
	<input checked="" type="checkbox"/>	<input type="checkbox"/>

19. Has the site of the proposed action or an adjoining property been the location of an active or closed solid waste management facility? If Yes, describe:	NO	YES
	<input checked="" type="checkbox"/>	<input type="checkbox"/>

20. Has the site of the proposed action or an adjoining property been the subject of remediation (ongoing or completed) hazardous waste? If Yes, describe: <u>Clay Town Landfill - DEC Site Code 734034. Remediation complete and property is outside of remedial boundaries and impacts.</u>	NO	YES
	<input type="checkbox"/>	<input checked="" type="checkbox"/>
I CERTIFY THAT THE INFORMATION PROVIDED ABOVE IS TRUE AND ACCURATE TO THE BEST OF MY KNOWLEDGE _____		
Applicant/sponsor/name: <u>Martin Voss</u> Date: <u>1/19/24</u>		
Signature: <u></u> Title: <u>OCDOT Commissioner</u>		

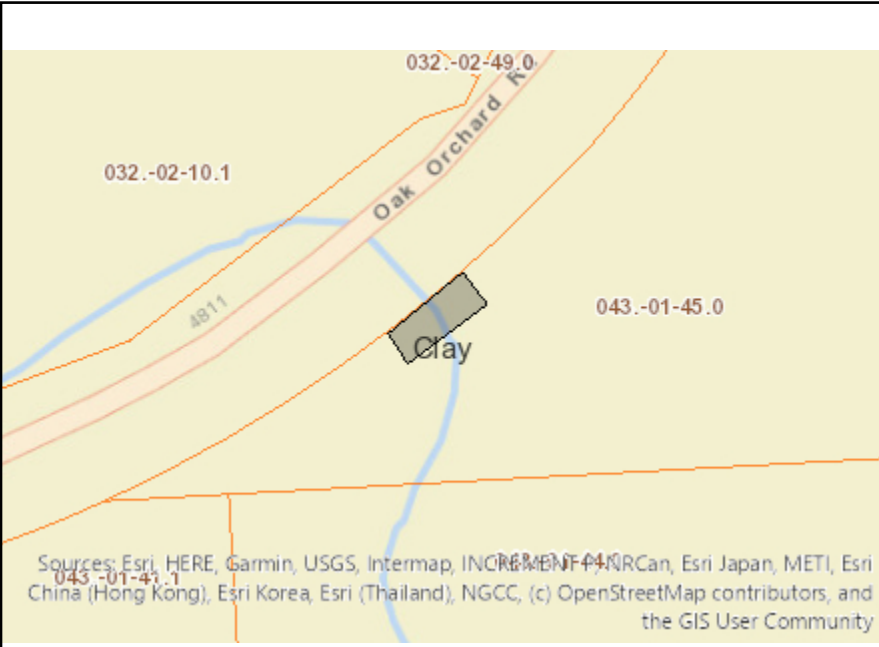

Disclaimer: The EAF Mapper is a screening tool intended to assist project sponsors and reviewing agencies in preparing an environmental assessment form (EAF). Not all questions asked in the EAF are answered by the EAF Mapper. Additional information on any EAF question can be obtained by consulting the EAF Workbooks. Although the EAF Mapper provides the most up-to-date digital data available to DEC, you may also need to contact local or other data sources in order to obtain data not provided by the Mapper. Digital data is not a substitute for agency determinations.



Part 1 / Question 7 [Critical Environmental Area]	No
Part 1 / Question 12a [National or State Register of Historic Places or State Eligible Sites]	No
Part 1 / Question 12b [Archeological Sites]	No
Part 1 / Question 13a [Wetlands or Other Regulated Waterbodies]	Yes - Digital mapping information on local and federal wetlands and waterbodies is known to be incomplete. Refer to EAF Workbook.
Part 1 / Question 15 [Threatened or Endangered Animal]	Yes
Part 1 / Question 15 [Threatened or Endangered Animal - Name]	Bald Eagle, Indiana Bat
Part 1 / Question 16 [100 Year Flood Plain]	No
Part 1 / Question 20 [Remediation Site]	Yes

Project:

Date:

Short Environmental Assessment Form

Part 2 - Impact Assessment

Part 2 is to be completed by the Lead Agency.

Answer all of the following questions in Part 2 using the information contained in Part 1 and other materials submitted by the project sponsor or otherwise available to the reviewer. When answering the questions the reviewer should be guided by the concept “Have my responses been reasonable considering the scale and context of the proposed action?”

	No, or small impact may occur	Moderate to large impact may occur
1. Will the proposed action create a material conflict with an adopted land use plan or zoning regulations?		
2. Will the proposed action result in a change in the use or intensity of use of land?		
3. Will the proposed action impair the character or quality of the existing community?		
4. Will the proposed action have an impact on the environmental characteristics that caused the establishment of a Critical Environmental Area (CEA)?		
5. Will the proposed action result in an adverse change in the existing level of traffic or affect existing infrastructure for mass transit, biking or walkway?		
6. Will the proposed action cause an increase in the use of energy and it fails to incorporate reasonably available energy conservation or renewable energy opportunities?		
7. Will the proposed action impact existing:		
a. public / private water supplies?		
b. public / private wastewater treatment utilities?		
8. Will the proposed action impair the character or quality of important historic, archaeological, architectural or aesthetic resources?		
9. Will the proposed action result in an adverse change to natural resources (e.g., wetlands, waterbodies, groundwater, air quality, flora and fauna)?		
10. Will the proposed action result in an increase in the potential for erosion, flooding or drainage problems?		
11. Will the proposed action create a hazard to environmental resources or human health?		

Short Environmental Assessment Form

Part 3 Determination of Significance

For every question in Part 2 that was answered “moderate to large impact may occur”, or if there is a need to explain why a particular element of the proposed action may or will not result in a significant adverse environmental impact, please complete Part 3. Part 3 should, in sufficient detail, identify the impact, including any measures or design elements that have been included by the project sponsor to avoid or reduce impacts. Part 3 should also explain how the lead agency determined that the impact may or will not be significant. Each potential impact should be assessed considering its setting, probability of occurring, duration, irreversibility, geographic scope and magnitude. Also consider the potential for short-term, long-term and cumulative impacts.

The action merely involves the acquisition of a portion of a vacant parcel of land for highways purposes. The property is needed to provide access to existing road and culvert infrastructure, and to permit any future monitoring, repairs, maintenance, and improvements thereto. Any future road or culvert improvements/repairs, information on which is at this time speculative, are functionally independent of this action to acquire fee title to property adjacent to the road for access and highway purposes. Such is no less protective of the environment considering that a SEQRA review would need to be completed prior to any future intrusive site activities associated with highway/culvert work, in addition to the need to obtain permits from regulatory agencies before performing any work in any around the water body.

Based on the foregoing, the County has determined that the above-stated action is an Unlisted Action that will not result in any significant adverse environmental impacts. Therefore, in accordance with Article 8 of the Environmental Conservation Law, the County hereby issues this negative declaration.

- ☐ Check this box if you have determined, based on the information and analysis above, and any supporting documentation, that the proposed action may result in one or more potentially large or significant adverse impacts and an environmental impact statement is required.
- ☒ Check this box if you have determined, based on the information and analysis above, and any supporting documentation, that the proposed action will not result in any significant adverse environmental impacts.

Onondaga County

1/19/24

Name of Lead Agency

Date

Martin Voss

OCDOT Commissioner

Print or Type Name of Responsible Officer in Lead Agency

Title of Responsible Officer



Signature of Responsible Officer in Lead Agency

Signature of Preparer (if different from Responsible Officer)

PRINT FORM

March 5, 2024

Motion Made By Ms. Cody

RESOLUTION NO. _____

2023 TRANSFER RESOLUTION

RESOLVED, that the following transfer be made:

<u>FROM:</u>	<u>TO:</u>	<u>AMOUNT:</u>
Admin Unit 0500000000	Admin Unit 0500000000	
Facilities Management	Facilities Management	
Speed Type #470030	Speed Type #470020	
Acct. 694130	Acct. 668720	
Maint, Util, Rents	Transfer to Grant Expenditures	\$210,000

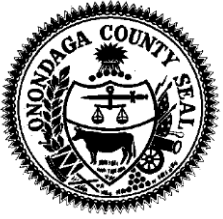

DEPARTMENT PROGRAM AND FINANCIAL INFORMATION SHEET

PURPOSE:

Purchase of Boom Lift, HVAC Filters and Upgrade to Mailroom equipment

OBJECTIVE/ WORK PLAN:

One-time purchase of boom lift (\$90,000), HVAC Filters (\$30,000) and upgrade to mailroom equipment (\$90,000).

Facilities currently does not own a boom lift to assist our trades/maintenance with higher area repairs/maintenance. We currently rent a lift when needed or hire contractors to do the work. Purchase of HVAC Filters will allow us to replace specialty filters that should be replaced every 3 years, this one-time purchase will allow us to replace the filters that were purchased in 2020. Our Mailroom VSort printer assembly that is part of our mail processing system is outdated and no longer can be supported by the manufacturer service provide, NPI. The software is driven by a Windows 7 version and cannot be upgraded to the newest version. The new server and the printer and other miscellaneous elements of the assembly need this investment to upgrade it to the current supported technology. If it were to malfunction now, we would be unable to process mail.

FUNDING SOURCE:

Utility savings

BUDGET:

\$210,000

March 5, 2024

Motion Made By Ms. Cody

RESOLUTION NO. _____

2023 TRANSFER RESOLUTION

RESOLVED, that the following transfer be made:

<u>FROM:</u>	<u>TO:</u>	<u>AMOUNT:</u>
Admin Unit 8100000000	Admin Unit 0500000000	
DSS-Economic Security	Facilities Management	
Speed Type #430814	Speed Type #470020	
Acct. 661180	Acct. 674600	
Medical Payment by State MMIS	Prov For Cap Projects, Capital	\$500,000
 <u>FROM:</u>	 <u>TO:</u>	 <u>AMOUNT:</u>
Admin Unit 8100000000	Admin Unit 0500000000	
DSS-Economic Security	Facilities Management	
Speed Type #430814	Speed Type #470020	
Acct. 661180	Acct. 674600	
Medical Payment by State MMIS	Prov For Cap Projects, Capital	\$500,000

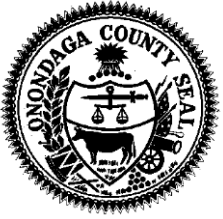

DEPARTMENT PROGRAM AND FINANCIAL INFORMATION SHEET

PURPOSE:

Facilities Various Capital Improvements

OBJECTIVE/ WORK PLAN:

Continue with renovations to the Civic Center 11th and 13th floors vacated by departments moving to other locations outside the Civic Center.

FUNDING SOURCE:

Cash

BUDGET:

\$500,000

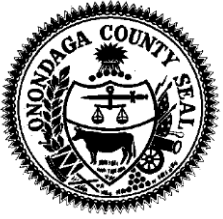

DEPARTMENT PROGRAM AND FINANCIAL INFORMATION SHEET

3b

PURPOSE:

OnCenter Rehabilitations

OBJECTIVE/ WORK PLAN:

Continuation of yearly improvements required to maintain the marketability and operations

FUNDING SOURCE:

Cash

BUDGET:

\$500,000

March 5, 2024

Motion Made By Ms. Cody

RESOLUTION NO. _____

2023 TRANSFER RESOLUTION

RESOLVED, that the following transfer be made:

<u>FROM:</u>	<u>TO:</u>	<u>AMOUNT:</u>
Admin Unit 6900000000	Admin Unit 6900000000	
Park and Recreation	Parks and Recreation	
Speed Type #510001	Speed Type #510012	
Acct. 693000	Acct. 667820	
Supplies & Materials	Transfer to Grant Expenditures	\$65,000
Admin Unit 6900000000	Admin Unit 6900000000	
Park and Recreation	Park and Recreation	
Speed Type #510003	Speed Type #510017	
Acct. 694130	Acct. 667820	
Maint, Utilities, Rents	Transfer to Grant Expenditures	\$60,000

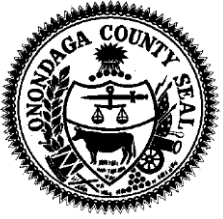

**DEPARTMENT OF:
PARKS AND RECREATION**

PROGRAM AND FINANCIAL INFORMATION SHEET

PURPOSE:

Shade structure would provide shelter from the sun and outdoor elements for waiting pickleball players.

OBJECTIVE/ WORK PLAN:

The plan would be to construct one shade structure. The structure would consist of a 15x15 shelter type structure with four legs and a removable canvas top.

FUNDING SOURCE:

Surplus in Supply Account

BUDGET:

\$65,000

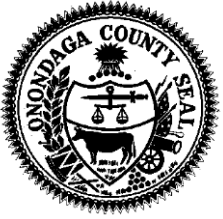

**DEPARTMENT OF:
PARKS AND RECREATION**

PROGRAM AND FINANCIAL INFORMATION SHEET

PURPOSE:

The radios the Park Rangers are currently using are twenty years old. This would update the Park Ranger communication system for the foreseeable future.

OBJECTIVE/ WORK PLAN:

This project would be a full replacement of all twenty two Park Ranger radios. The project will also include the purchase of three spare radios as well as programming, new radio holsters and charging stations.

FUNDING SOURCE:

Surplus in Maintenance Utilities and Rents

BUDGET:

\$60,000

March 5, 2024

Motion Made By Ms. Cody

RESOLUTION NO. _____

2023 TRANSFER RESOLUTION

RESOLVED, that the following transfer be made:

<u>FROM:</u>	<u>TO:</u>	<u>AMOUNT:</u>
Admin Unit 6500000000	Admin Unit 6500000000	
OCPL	OCPL	
Speed Type #390114	Speed Type #390114	
Acct. 694080	Acct. 667820	
Professional Services	Transfer to Grant Expenditures	\$26,100
 Admin Unit 6500000000	 Admin Unit 6500000000	
 OCPL	 OCPL	
 Speed Type #390040	 Speed Type #390040	
 Acct. 694130	 Acct. 667820	
 Maint, Utilities, Rents	 Transfer to Grant Expenditures	 \$17,900
 Admin Unit 6500000000	 Admin Unit 6500000000	
 OCPL	 OCPL	
 Speed Type #390040	 Speed Type #390040	
 Acct. 694130	 Acct. 667820	
 Maint, Utilities, Rents	 Transfer to Grant Expenditures	 \$4,500
 Admin Unit 6500000000	 Admin Unit 6500000000	
 OCPL	 OCPL	
 Speed Type #390133	 Speed Type #390133	
 Acct. 694130	 Acct. 667820	
 Maint, Utilities, Rents	 Transfer to Grant Expenditures	 \$67,000

**Program and Financial Information Sheet
Onondaga County Legislative Request
2023 Year End**

PURPOSE:

Onondaga County Public Libraries is seeking legislative approval and financial support for the replacement of public computers at the Central Library.

BACKGROUND:

Public access computers is one of the most demanded services at Onondaga County Public Libraries. Currently we have approximately 160 Public Access Computer offerings across our Central Library, 8 city branches, and 2 satellite libraries located within the Southwest and Northeast Community Centers. The current fleet of Dell Thin Clients is diminishing in performance as the machines are well past their typical lifespan. Additionally, we are unable to update the PCs to our minimum standard of operating system due to the physical limitations of these machines.

We began the process of replacing these antiquated devices in 2023 in our branches and are continuing the process in 2024. We are still in need of funding to replace our inventory in the Central Library downtown. Upgrading our offerings will result in a greater experience for our patrons and a reduction of staff time being directed toward troubleshooting or repairing faulty computers.

BUDGET:

\$26,100

Central Library located at 447 South Salina Street, Syracuse, NY 13202-2494
Phone 315-435-1900 Fax 315-435-8533 www.onlib.org
Dawn Marmor, Executive Director

Beauchamp Branch * Betts Branch * Hazard Branch * Mundy Branch
Paine Branch * Petit Branch * Soule Branch * White Branch

**Program and Financial Information Sheet
Onondaga County Legislative Request
2023 Year End**

PURPOSE:

Onondaga County Public Libraries is seeking legislative approval and financial support for the replacement of security cameras at the Beauchamp Branch Library.

BACKGROUND:

Beauchamp Branch Library is located at 2111 S. Salina Street (corner of E. Colvin & S. Salina Street). It is a busy library with a lot of pedestrian traffic. Currently the security camera system is not operational and cannot be restored by the county contracted vendor that maintains the security systems, Johnson Controls Security Solutions. After many service calls throughout 2023 it has been determined that it is best to replace the entire security system at this location.

The original cameras were installed six years ago using New York State construction aid for libraries but have reached end of life. Replacement plans include all the interior and exterior cameras as well as the computer terminal that stores video footage. Failure to replace this system will hinder our security vendor's ability to properly monitor the library areas for safety purposes.

BUDGET:

\$18,000

Central Library located at 447 South Salina Street, Syracuse, NY 13202-2494
Phone 315-435-1900 Fax 315-435-8533 www.onlib.org
Dawn Marmor, Executive Director

Beauchamp Branch * Betts Branch * Hazard Branch * Mundy Branch
Paine Branch * Petit Branch * Soule Branch * White Branch

**Program and Financial Information Sheet
Onondaga County Legislative Request
2023 Year End**

PURPOSE:

Onondaga County Public Libraries is seeking legislative approval and financial support for the purchase of drinking fountains for three of its branch libraries.

BACKGROUND:

Currently, four of the eight city branch libraries do not have drinking fountains. Each summer during summer reading and other library children's programs there is a need to distribute water at the branches that do not have drinking fountains. Currently staff at the branches hand out small cups that children take to fill from sinks in the bathrooms which is not an ideal solution.

The county facilities department has evaluated the four libraries in need of drinking fountains and determined that three of them (Beauchamp, Soule and White branches) have the appropriate plumbing in place to install drinking fountains.

Not installing these drinking fountains would result in the continued deficit of drinking water for patrons and staff at these county locations.

BUDGET:

\$4,500

Central Library located at 447 South Salina Street, Syracuse, NY 13202-2494
Phone 315-435-1900 Fax 315-435-8533 www.onlib.org
Dawn Marmor, Executive Director

Beauchamp Branch * Betts Branch * Hazard Branch * Mundy Branch
Paine Branch * Petit Branch * Soule Branch * White Branch

**Program and Financial Information Sheet
Onondaga County Legislative Request
2023 Year End**

PURPOSE:

Onondaga County Public Libraries is seeking legislative approval and financial support for the purchase of a replacement vehicle with wrapping to be used in its delivery system.

BACKGROUND:

One of the essential services listed as part of the memorandum of understanding between the Onondaga County Central Library and the 19 suburban member libraries is a delivery system tasked with the distribution of outgoing and incoming materials throughout the 32 site library network. Over 8,000 stops are conducted annually to deliver and retrieve materials borrowed by library patrons at their library of choice.

One of the main resources required to operate this system is its fleet of vehicles. The delivery system's vehicle inventory includes 4 cargo vehicles ranging in age from 9 years to 12 years of age and have all been driven at or above 100,000 miles. There has been over \$71,000.00 in repair expenses incurred by this fleet of vehicles and as the fleet ages, the maintenance costs rise exponentially. One of the older vehicles (a Ford E350 Cargo Van) accounts for 44% of the total fleet maintenance expense.

The vehicle that has been identified as a viable replacement for the vehicle that has reached end of life is a Ford Transit 350 XLT Cargo Van. The MSRP is \$62,000 and the vehicle wrapping is \$5,000. Keeping this vehicle fleet current is a critical component to having a viable county wide library delivery system. Not addressing the need to replace these aging vehicles would begin to cause major delays in the transport of library materials as the vehicles continue to need significant repairs that keep them off the road.

BUDGET:

\$67,000

Central Library located at 447 South Salina Street, Syracuse, NY 13202-2494

Phone 315-435-1900 Fax 315-435-8533 www.onlib.org

Dawn Marmor, Executive Director

Beauchamp Branch * Betts Branch * Hazard Branch * Mundy Branch

Paine Branch * Petit Branch * Soule Branch * White Branch